

LAYFLAT HOSE AND FITTINGS

For all your fluid pumping needs

KETEK'S LAYFLAT HOSE IS DURABLE AND LONG-LASTING

It's highly resistant to common chemicals and has excellent resistance to UV radiation, hydrolysis and fungus degradation. The abrasion resistance is one of the highest available, making it ideal for mines and other challenging environments.



8", 10" and 12"
diameters available



200 metre lengths



Reel sold separately.
Custom colours and
logos available

- **ABRASION:** 4000 DIN CYCLES
- **TEMPERATURE RANGE:** -50C TO 80C (-58F TO 176F)
- **COMES WITH TEMPORARY SHIPPING REEL (NOT SHOWN)**



KETEK
GROUP

Results Driven.

Layflat hose and fittings



Ketek's layflat hose is reinforced with circular woven filament polyester yarn. This method gives a strong bond between the cover and the lining and firmly encapsulates the woven polyester.

I.D.		TOLERANCE		WALL THICKNESS		WORKING PRESSURE		BURSTING PRESSURE		WEIGHT		ELONGATION AT WP(%)		EXPANSION AT WP(%)		part#
inches	mm	mm	inches	mm	psi	psi	lbs/ft	tolerance lbs/ft	kgs/m	tolerance kgs/m	max	max				
8"	204	204-207	0.150 ± 0.012	3.8±0.3	200	600	1.94	±0.134	2.90	± 0.2	≤1	≤10	217130			
10"	254	256-259	0.165 ± 0.016	4.2 ± 0.4	200	600	2.75	± 0.201	4.10	± 0.2	≤1	≤10	217140			
12"	306	306-311	0.165 ± 0.016	4.2 ± 0.4	150	450	3.33	± 0.201	4.97	± 0.3	≤1	≤8	217150			

Couplings



8" layflat hose (Part # 217160)

- Aluminum couplings with groove ends
- 200m per roll
- Working pressure: 200 psi



10" layflat hose (Part # 217180)

- Aluminum sexless swivel couplings
- 200m per roll
- Working pressure: 200 psi



12" layflat hose (Part # 217170)

- Aluminum couplings with groove ends
- 200m per roll
- Working pressure: 150 psi

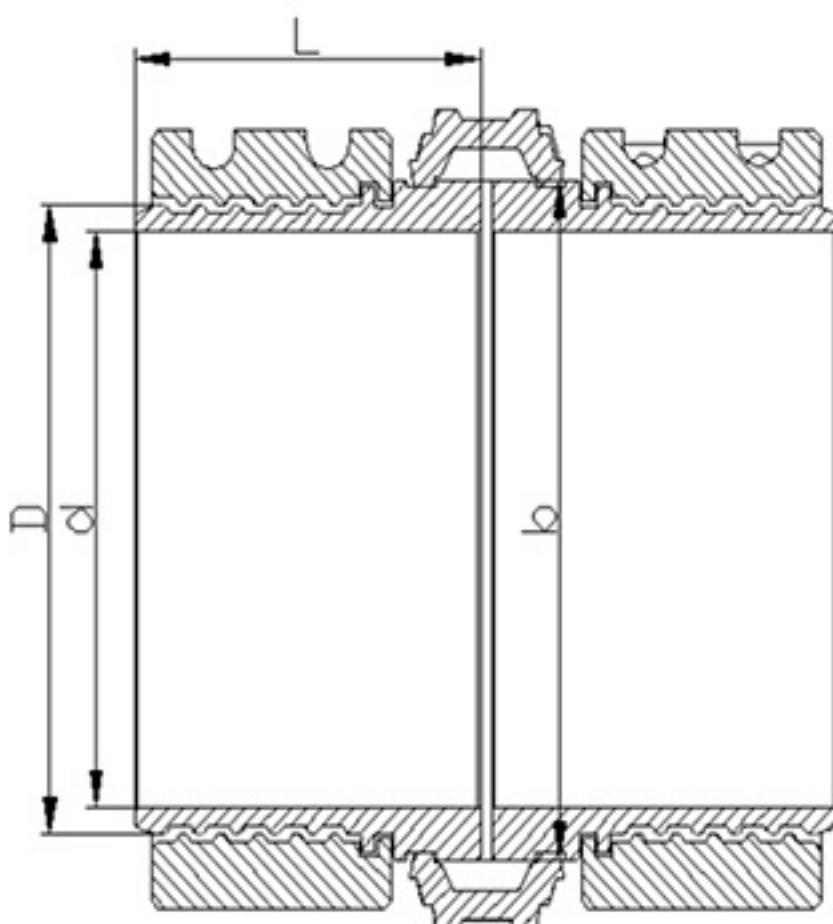

Designation	8"	10"	12"
D (mm.)	201.4	253.4	302.9
d (mm.)	184.6	232.1	275.1
b (mm.)	219.4	273.1	324.1
L (mm.)	150	150.9	154.9
Service Pressure (MPa)	2.5	2.5	2
Burst Pressure (MPa)	10	10	8
Material Construction	Aluminum		
Weight (Kg)	20.5	17	23



Contact Ketek
855-447-5050
Info@ketek.ca

Visit
ketek.ca